

READ ALL THESE INSTRUCTION BEFORE INSTALLING

**WARNING - RISK OF FIRE AND ELECTRICAL SHOCK. FIXTURE MUST BE INSTALLED BY A QUALIFIED ELECTRICIAN ONLY. FIXTURE IS INTENDED FOR INSTALLATION IN ACCORDANCE WITH THE NATIONAL ELECTRICAL CODE, LOCAL AND FEDERAL SPECIFICATIONS. DISCONNECT POWER AT ELECTRICAL PANEL BEFORE SERVICING. CONNECTION OF LUMINAIRE TO POWERED DRIVER WILL RESULT IN PERMANENT DAMAGE TO THE LED AND VOIDED PRODUCT WARRANTY.**

**RETAIN THESE INSTRUCTIONS FOR MAINTENANCE REFERENCE.**

1. THE DIVA SURFACE MOUNT REQUIERES A J-BOX PREVIOUSLY INSTALLED AND WITH LINE VOLTAGE ALREADY FED TO IT. FOLLOW THE TABLE FOR PROPER J-BOX COMPAITABILITY.

2. UNSCREW 4X SCREWS FROM THE FIXTURE TO SEPARATE THE COVER

3. ATTACH THE COVER OF THE DIVA SURFACE MOUNT TO THE CEILING BY SCREWING IT TO THE J-BOX WITH 2X SCREWS PROVIDED (BY OTHERS). RUN THE LINE, NEUTRAL AND GROUND WIRES THROUGH THE MIDDLE OPENING OF THE COVER.

4. HANG THE DIVA SURFACE MOUNT FIXTURE TO THE COVER USING PROVIDED TETHERS LOCATED ON EACH SIDE OF THE FIXTURE. WHILE THE FIXTURE IS SUSPENDED, PROCEED TO WIRE THE FIXTURE TO THE MAIN LINES. USING PROVIDED WAGO CONNECTORS, CONNECT THE NEUTRAL WIRE TO THE FIXTURE WHITE WIRE, THE HOT WIRE TO THE FIXTURE BLACK WIRE AND THE GROUND WIRE TO THE FIXTURE GREEN WIRE.

5. SECURE THE FIXTURE TO THE COVER USING THE 4 X SCREWS.

6. ORIENT EACH LIGHT ENGINE TO ACHIEVE THE DESIRED LIGHT DISTRIBUTION. MAKE SURE THAT NO TWO LIGHT ENGINE TOUCH EACH OTHER. PROCEED TO SWITCH POWER ON

1.

Diva 2SS,2SD & 2ST	No J-box
Diva 3SS,3SD & 3ST	3.5" J-BOX
Diva 5SS,5SD, 5ST, 5SQ, 2SQ & 3SQ	4" J-BOX

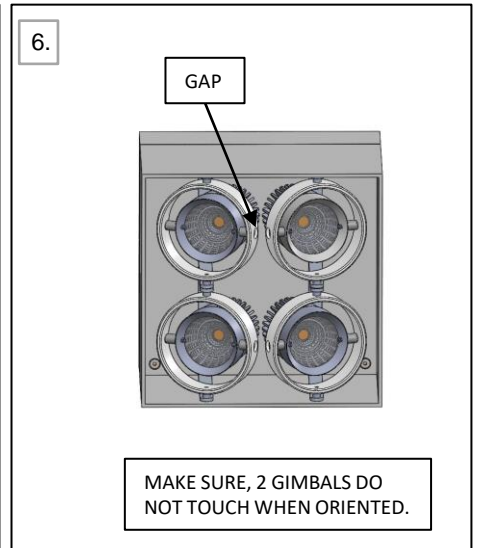
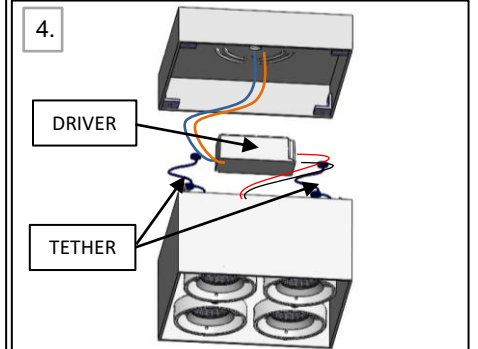
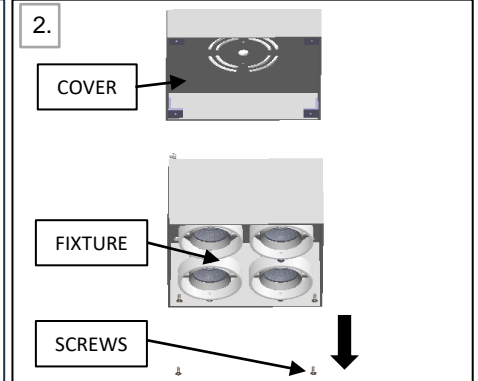
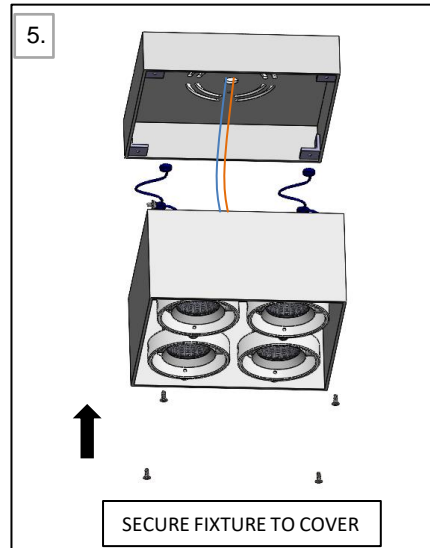
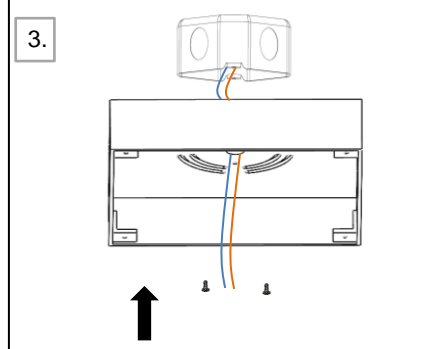
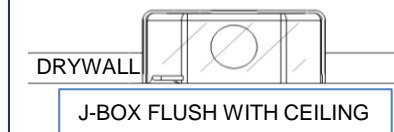

**0-10 Driver (1 Driver for 2 Heads)**

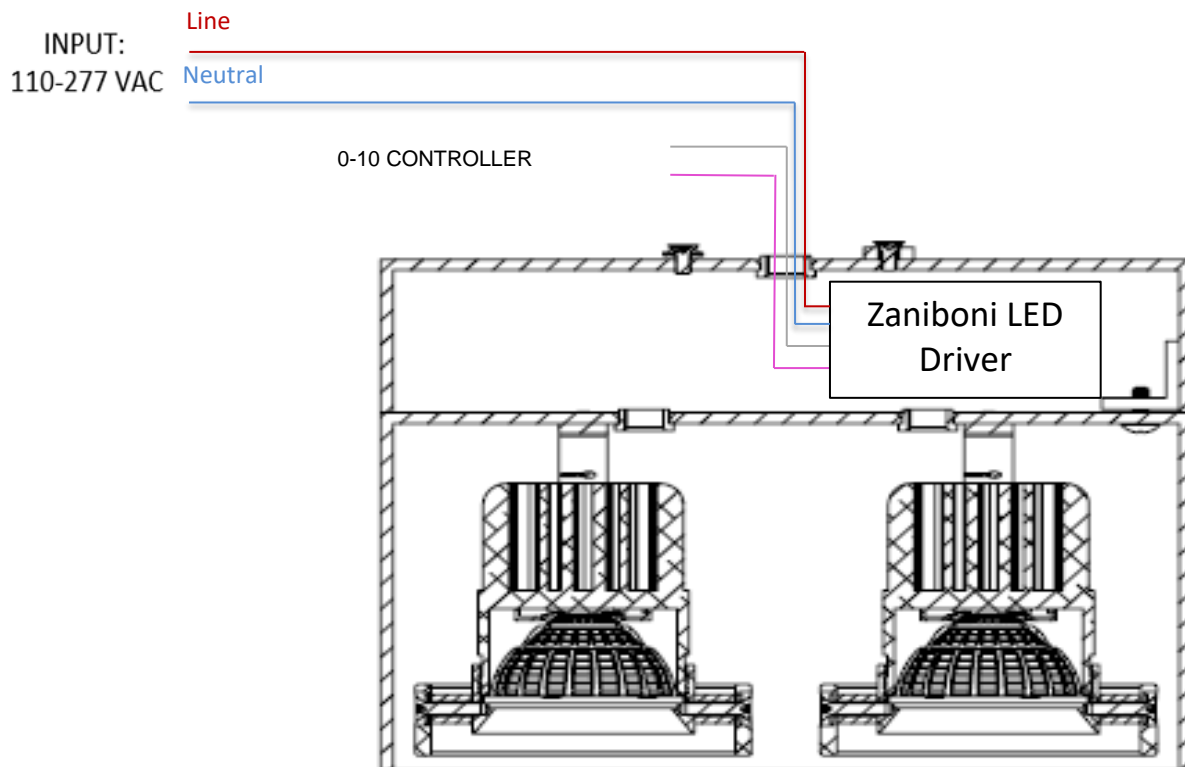

ELV, Non-Dim, Bluetooth Driver

